

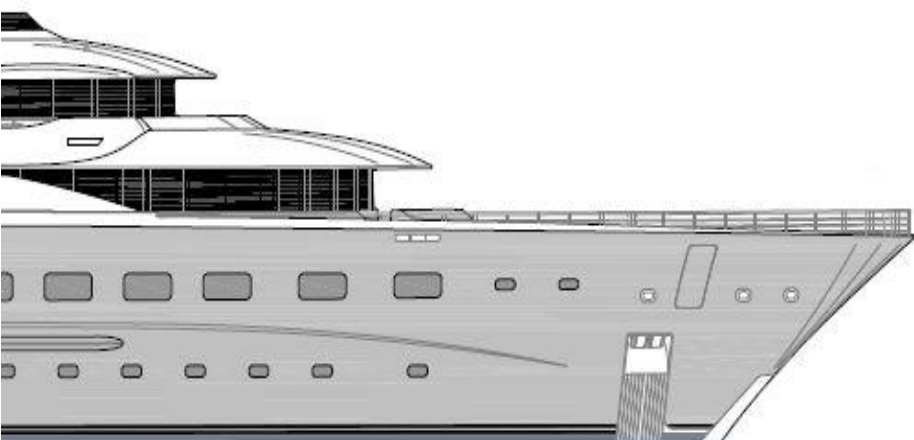

FUCHS
Fördertechnik AG

FUCHS MAN-RIDING HOOKS FOR LUXURY YACHTS



THE INTELLIGENT HOOK SYSTEM:

- Type approved by DNV GL
- Usable for man-riding and normal load cases
- Compact design with low headroom and integrated hook weight (size S, M or L)
- Swivel hook for fibre and wire ropes
- Self-locking when hook is loaded
- Easy and ergonomic unlocking
- Safety factor 6x SWL
- Forged stainless steel
- High gloss polished





TECHNICAL SPECIFICATION:

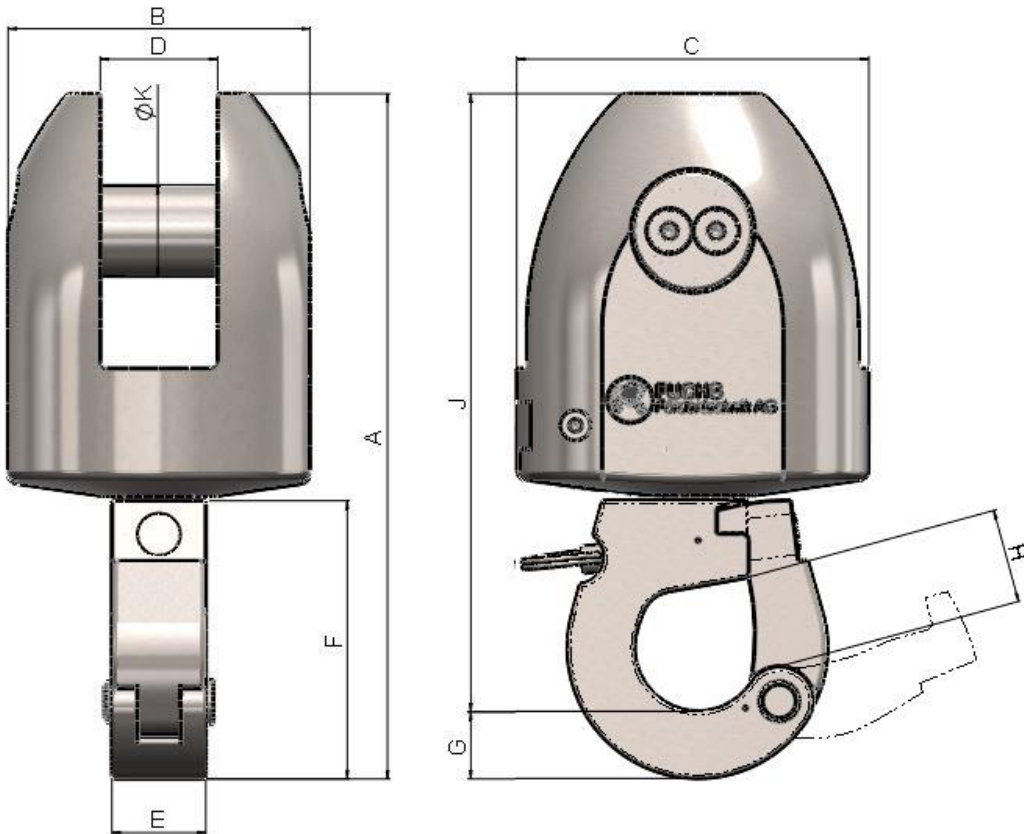

Type	SWL max. [t]	Dimension [mm]										Approx. Weight (kg)	Art. No.
		A	B	C	D	E	F	G	H	J	K		
FH1(S)	2	175	90	105	24	28	111	20	28	195	27	5,4	100009
FH1(M)	3	180	90	105	31	28	111	20	28	200	27	5,4	100010
FH1(L)	4	185	90	105	35	28	111	20	28	205	27	5,4	100011